

EN, Edition 1  
2024-03-06

**ahlsell**

**Manual**

# **Globe check valve**

**AVI 1671**



**a-c**  
**a·collection**

EN 4950594

# Globe check valve AVI 1671



## Design

Globe check valve, oblique, made from stainless steel, internal thread. Seals made from PTFE

## Application area

Check valve for neutral and aggressive liquids such as alkalis, acids, oils within the chemicals industry and gases.

## Dimensions

DN10–DN50

## Pressure and Temperature

PN50 -20–+230°C.

## Approval

The valve meets the requirements for CE marking according to the Pressure Equipment Directive – CE/PED 97/23/EC Category 3, Module H, CE0035.

## Installation

Observe the flow direction arrow on the valve housing.

## Maintenance

The valve is maintenance-free but should be moved regularly.

## Technical specifications

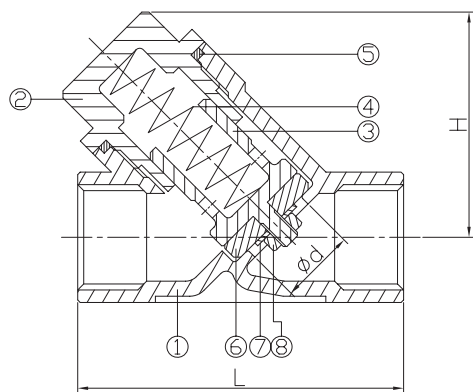

RSK	DN	d	L	H	Kv (m <sup>3</sup> /h)	Weight (kg)
4950594	10	10	57	32	1,3	0,3
4950595	15	15	61	37	1,5	0,3
4950596	20	20	70	41	3	0,4
4950597	25	25	86	47	5,45	0,6
4950598	32	32	100	54	8	0,9
4950599	40	38	111	62	12,08	1,2
4950600	50	51	138	76	18,8	1,7

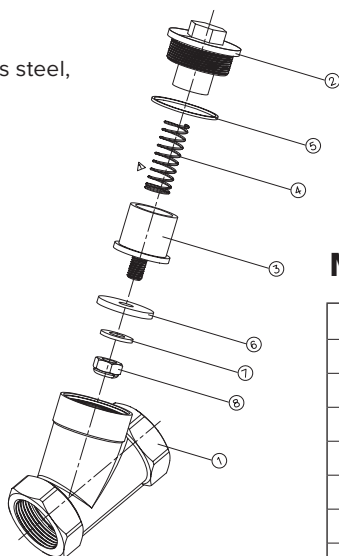

## Material specifications

No.	Name	Material
1	Valve housing	EN 1.4408
2	Cover	EN 1.4408
3	Nut	EN 1.4408
4	Washer	SS316
5	Seat	PTFE
6	Piston	PTFE
7	Spring	SS316
8	Cover seal	SS316

## Pressure and temperature diagram

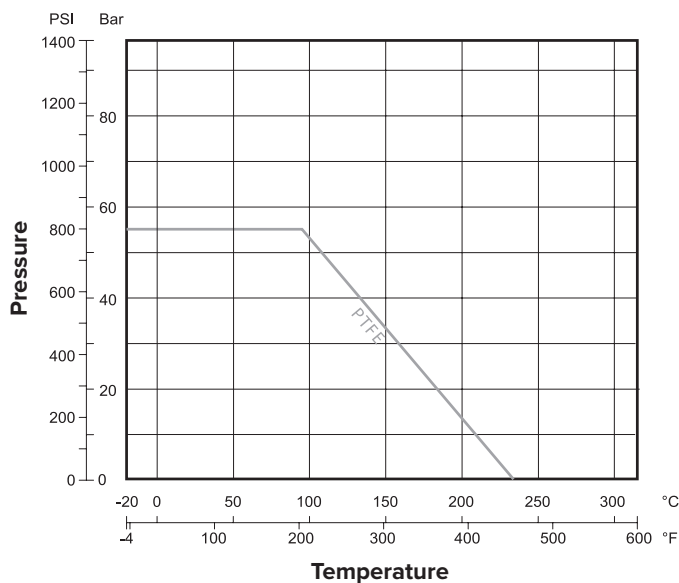

## Opening pressure

DN	mBar
10	29
15	29
20	29
25	31
32	31
40	32
50	35